

AW-D111 is an intelligent addressable supervisory module, which can be configured with Asenware AW-FP100 Series Addressable Fire Alarm Control Panel.

Each point (device) can be given specific ID or individual address, which allows the panel to continuously monitor specific location (point).

This module can be connected to control valves, zone valves (Relay input), in order to monitor the changes of these devices .

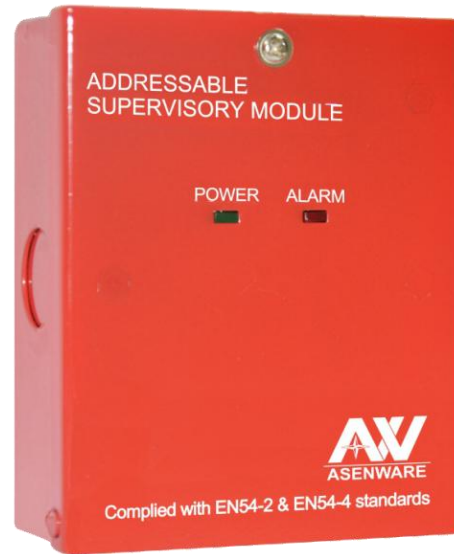

## Features

- ✓ Reliable communication protocol
- ✓ Two LEDs one is Green, which blinks in normal condition and another one is Red which becomes steady during fire alarm condition
- ✓ Remote test from Panel

## Installation

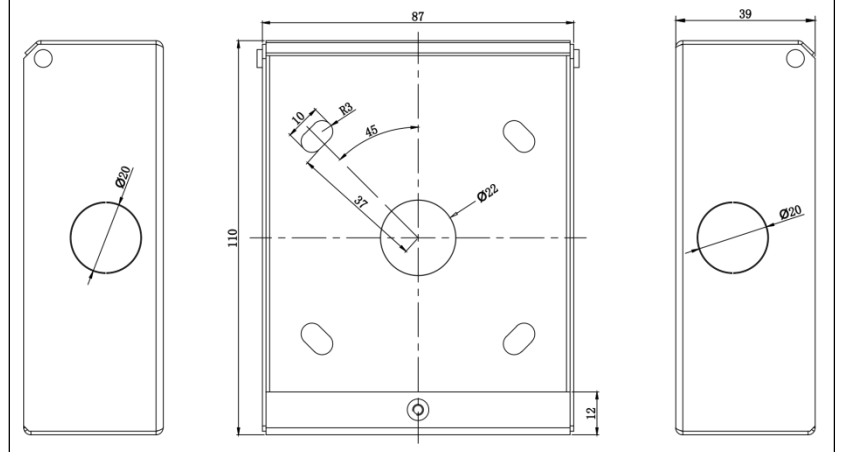

## Technical Specification

Model	AW-D111
Operating voltage	18~28VDC @Loop
Operating current(@Loop 24VDC)	Monitoring status≤5mA, Aux output≤200mA
Wiring	The promise of two bus system(Loop in, Loop out)
Protection level	IP 30
Supervisory contact	Dry relay
Environmental	Temperature range: -10 ~50°C (14~122°F) Humidity: 5 to 95% RH, non-condensing
Mating host	AW-FP100 series fire alarm control panel
Size (L*W*H)	110mm* 87mm* 39mm
Weight	About 320g